



## Merry Hill Road Bushey Offers over £900,000

A beautifully presented, four bedroom house available with spectacular views and in an excellent location for local schools.

On the ground floor the house has an open plan kitchen and living room perfect for families with space to dine, play and entertain. Folding doors lead to the over 200' garden including a patio, lawn, outbuilding and gate leading to Hill Mead Nature Park and Hartsbourne Golf Course. There is also a separate formal reception room and guest WC.

Upstairs, on the first floor the house has two large double bedrooms, an additional single bedroom and a family bathroom. The top floor, in the loft conversion, houses the master bedroom and ensuite shower room, with a picturesque window offering an amazing view.

The house is available with off street parking at the front for multiple cars, and extension potential on the ground and first floors.

Hertsmere Council Tax Band E.

### Viewing

Please contact our Davidson Frost-Wellings Office on 020 8954 8806 if you wish to arrange a viewing appointment for this property or require further information.

- Four Bedrooms
- Two Bathrooms
- Spectacular Views
- Over 200' South-Facing Garden
- Excellent Location
- Semi Detached Freehold

# Floor Plan

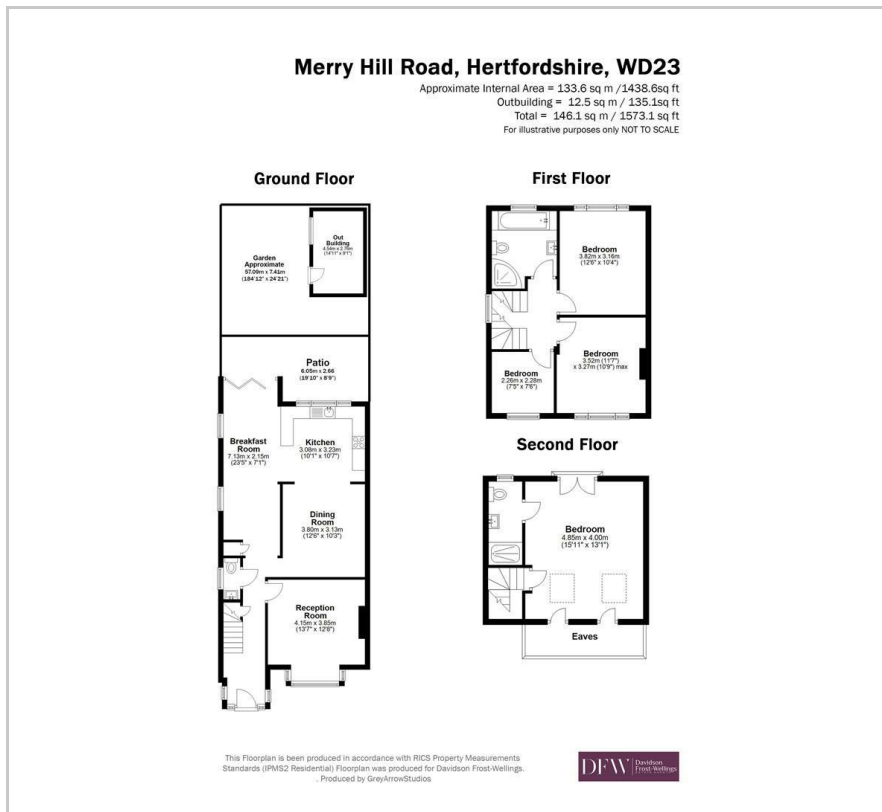

# Area Map

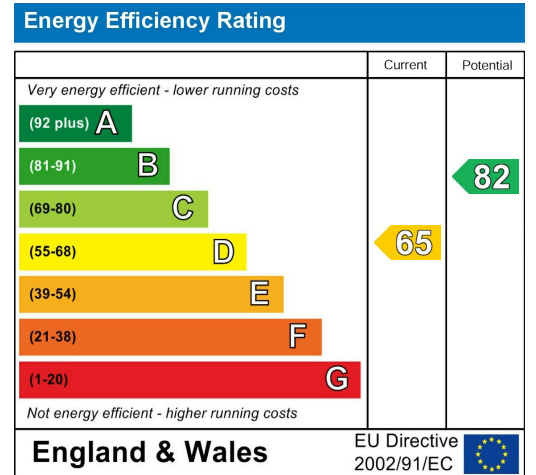
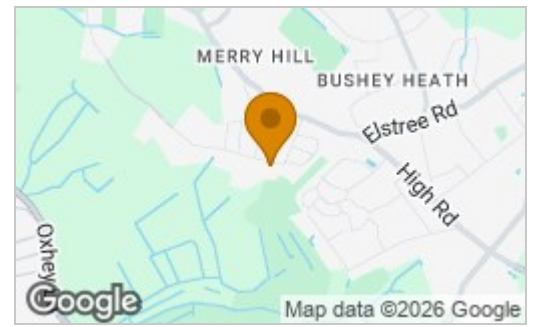

These particulars, whilst believed to be accurate are set out as a general outline only for guidance and do not constitute any part of an offer or contract. Intending purchasers should not rely on them as statements of representation of fact, but must satisfy themselves by inspection or otherwise as to their accuracy. No person in this firm's employment has the authority to make or give any representation or warranty in respect of the property.